

SHIRLEY VALENTINE

NEPTUNE THEATRE  
 DESIGNER - ALLEN MARTINIS  
 DESIGN - SERIAL CATER

CONCEPT RENDERINGS

DEAD DATE NOV 15 '91  
 SHOW DATE MARCH 6 '92

DRAW NO 1/1  
 FINALS

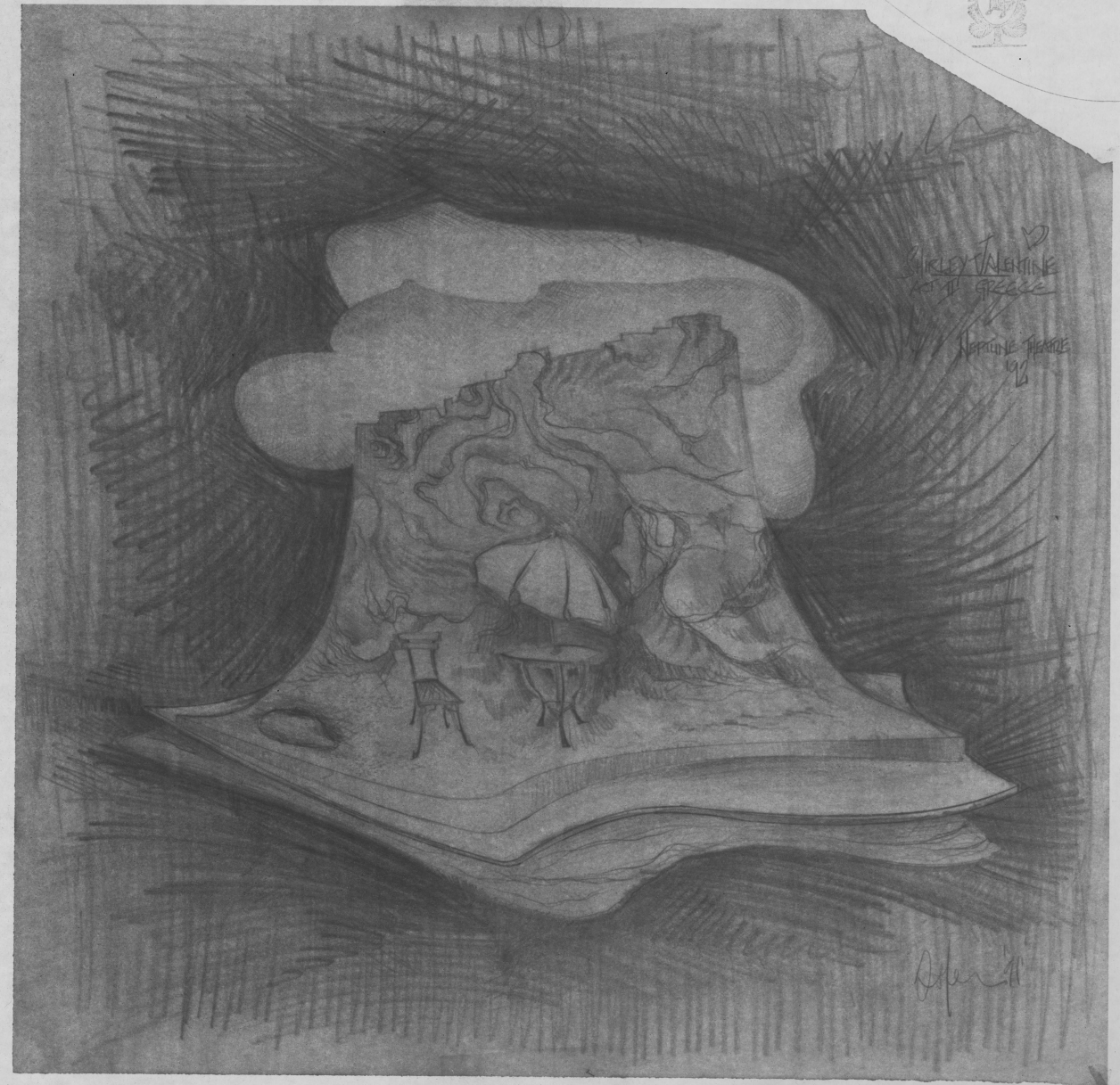

LIVE SET #2.  
 ACT I - A JOINING SCRIM ~~TO THE MAIN SET EDGE (KITCHEN)~~ LIFTS AS THE SET ROLLS FORWARD TO A POINT BENEATH THE PROSCENIUM AS INDICATED IN FIG. A DRAW NO II/II  
 - END OF ACT I - THE STAGE RECESSES + SCRIM FALLS. KITCHEN IS STRUCK.  
 ACT II - SCRIM RISES - THE KITCHEN REMOVED, LARGER GREECE + SHIRLEY ON THE BEACH  
 - AS THE STAGE AGAIN ROLLS FORWARD, THE CLOUD UNITS DESCEND ONE FOLLOWING THE OTHER  
 - THE STAGE TRUCK UNIT IS OPERATED FROM THE REAR THROUGHOUT.  
 TOURING CONSIDERATIONS. - THE BASIC GREECE + KITCHEN PROPORTIONS RELATE TO THE CHESTER THEATRE RESTRICTING THE DIMENSIONS TO 15' x 15' x 12' HIGH  
 - CONSEQUENTLY THE "BEACH/WATER" UNITS + "CLOUD" UNITS WOULD NOT BE PART OF THE TOURING PRODUCTION.

AERIAL

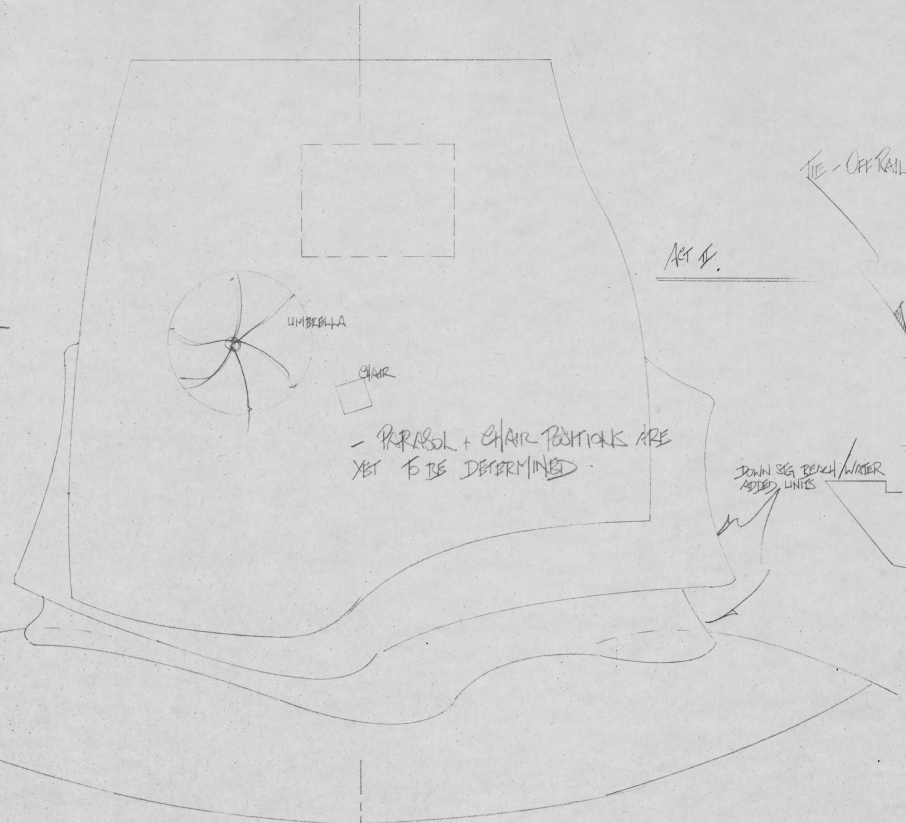

THE OFF RAIL

Act II

LS #20

LS #19

LS #17

DOWN 3/4 BENCH / WATER  
SLOPED UNITS

AERIAL

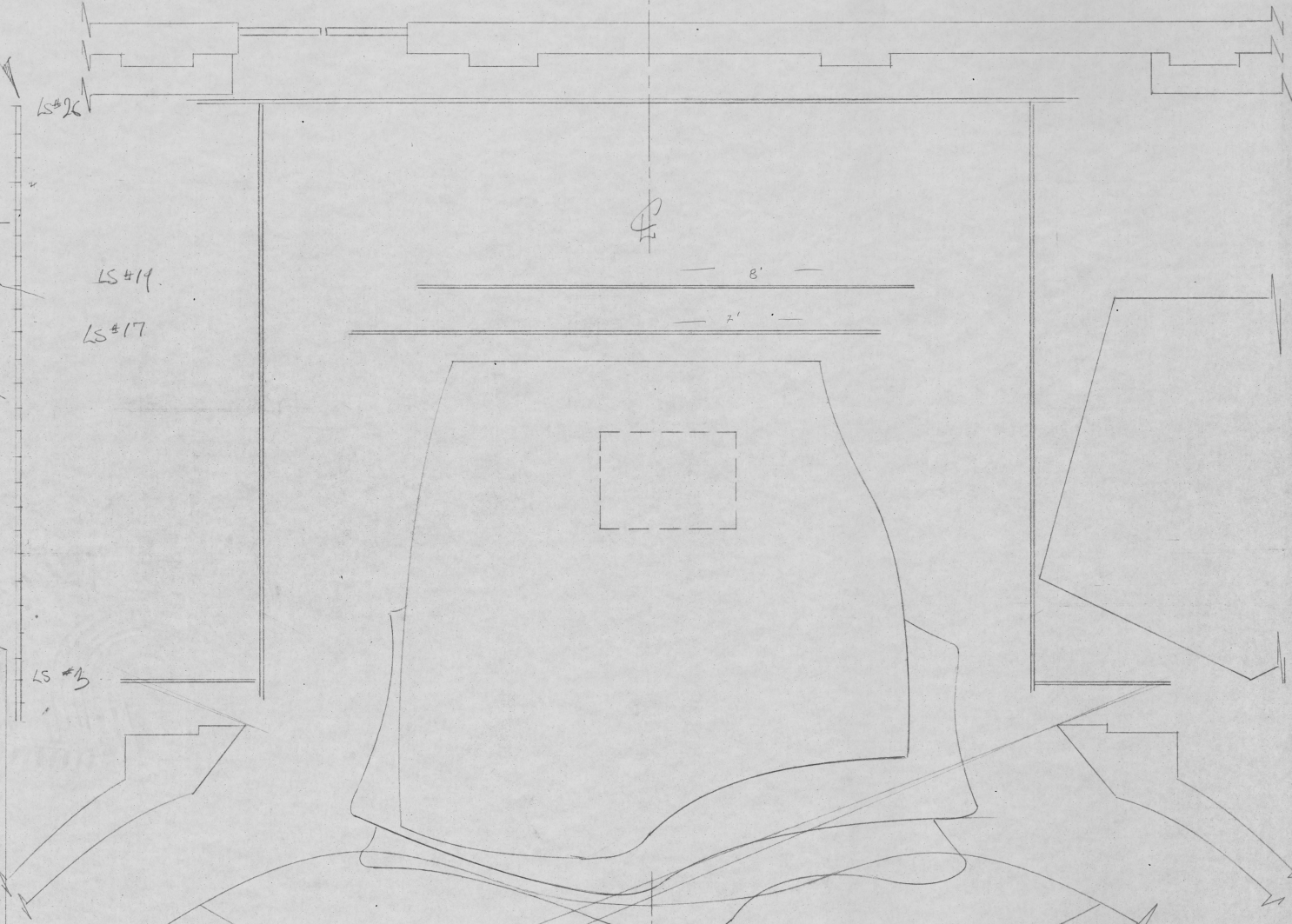

FRONTAL

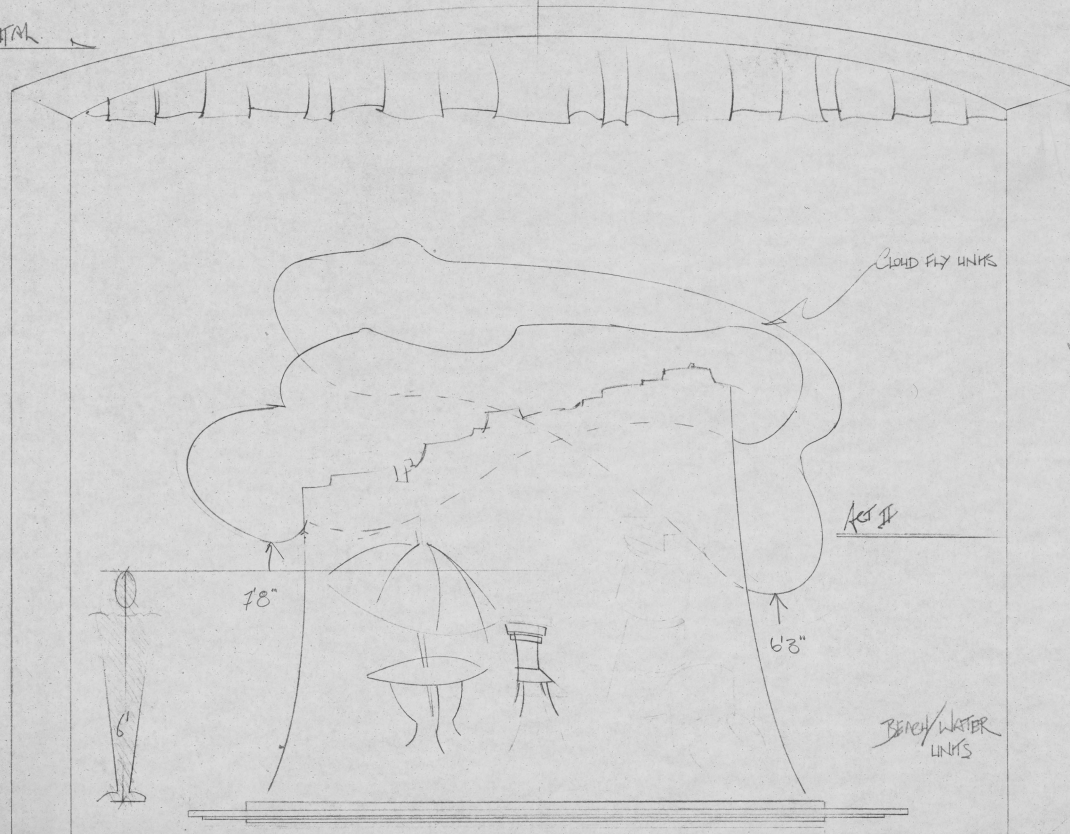

LS #3

SHIRLEY VALENTINE  
NEPTUNE THEATRE  
DIRECTOR - ALLEN MACINNIS  
DESIGN - STEPHEN OBER  
DRAWN TITLE / FLOOR PLAN  
+ ELEVATION  
DRAW DATE - NOV 15/91  
SHOW DATE - MARCH 6/92  
SCALE 1/4" = 1 FOOT ± 0.1  
DRAWN BY - S. FINNIS

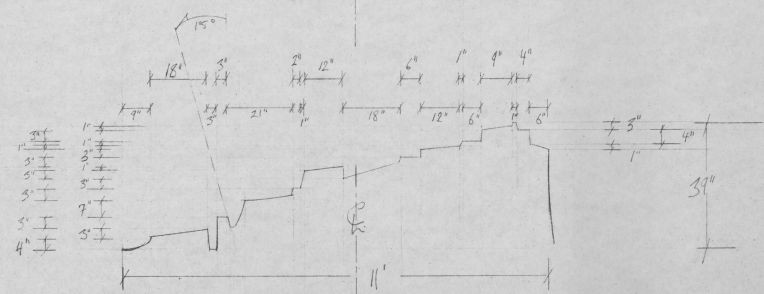
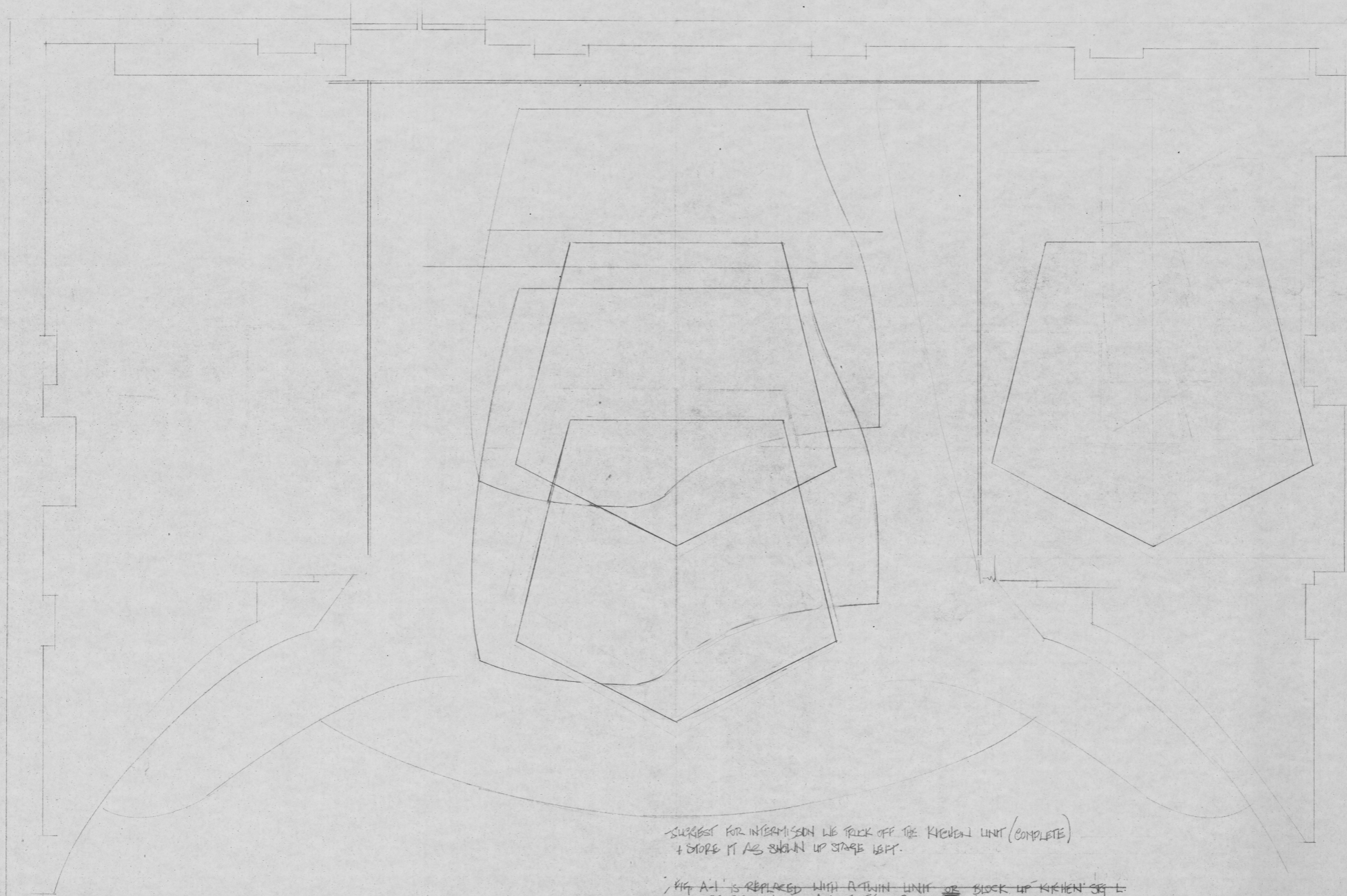

FIGURE 'A'



FIT TO GRECKE SHELL



SUGGEST FOR INTERMISSION WE TRUCK OFF THE KITCHEN UNIT (COMPLETE)  
+ STORE IT AS SHOWN UP STAGE LEFT.

~~FIG. A-1 IS REPLACED WITH A TWIN UNIT OR BLOCK UP KITCHEN SEG L  
AND REPOSITION FIG. A-1 TO ITS ORIGINAL PLACE.~~

~~I WOULD SUGGEST SAME PROCEDURE FOR SEG R KITCHEN BUT I BELIEVE  
THERE IS NO ROOM FOR STORAGE.~~

FOR THE TOUR - KITCHEN SITS ON THE GRECKE SHELL, BEING A GROUND CLOTH  
FOR KITCHEN FLOOR + ADDING FIG. 'A' TO THE 1ST ACT TO COMPLETE THE OTHERWISE RAISED KITCHEN FLOOR.

SHIRLEY VALENTINE  
NEPTUNE THEATRE  
DIRECTOR ALLEN MACINNIS  
DESIGN - STEPHEN OSLER  
DRAWN BY A.C. CHAMBERLAIN  
SHOW DATE - MARCH 6th / 1992  
SCALE 1/2" = 1 FOOT 10"  
DRAWN BY *[Signature]* FINIS

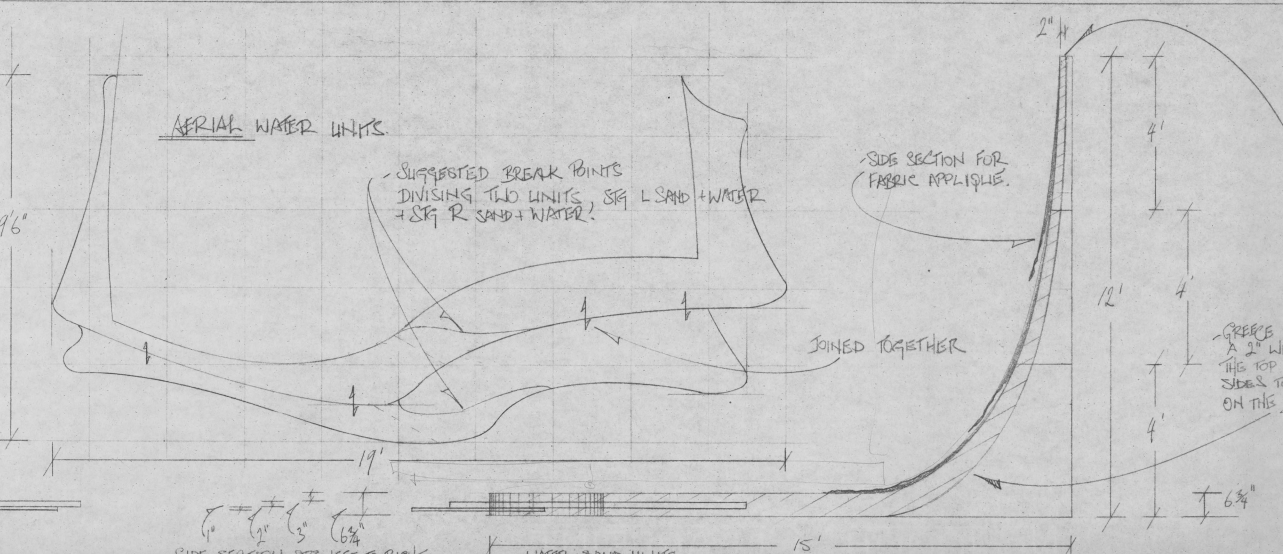
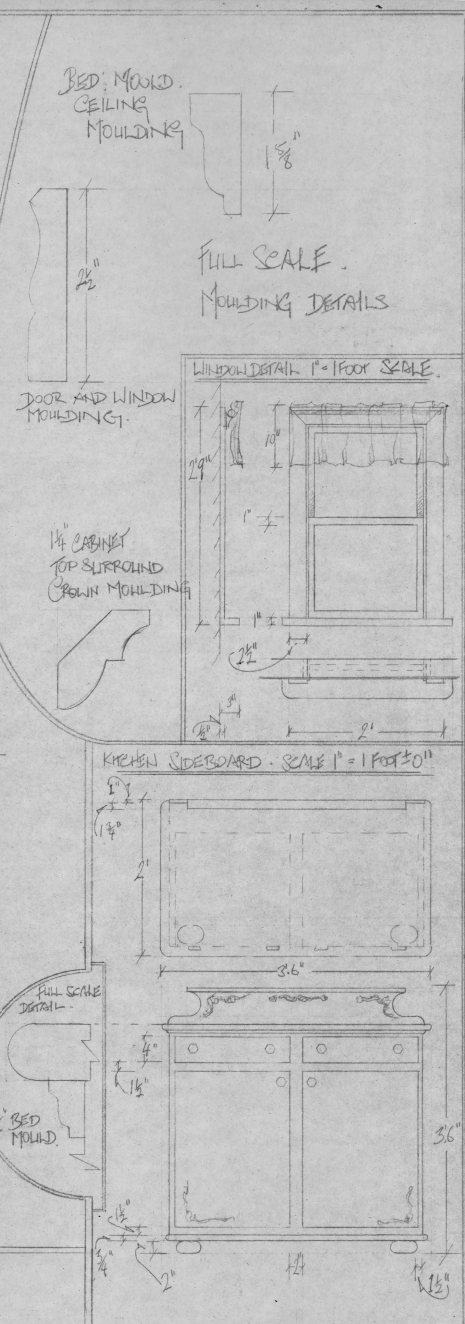
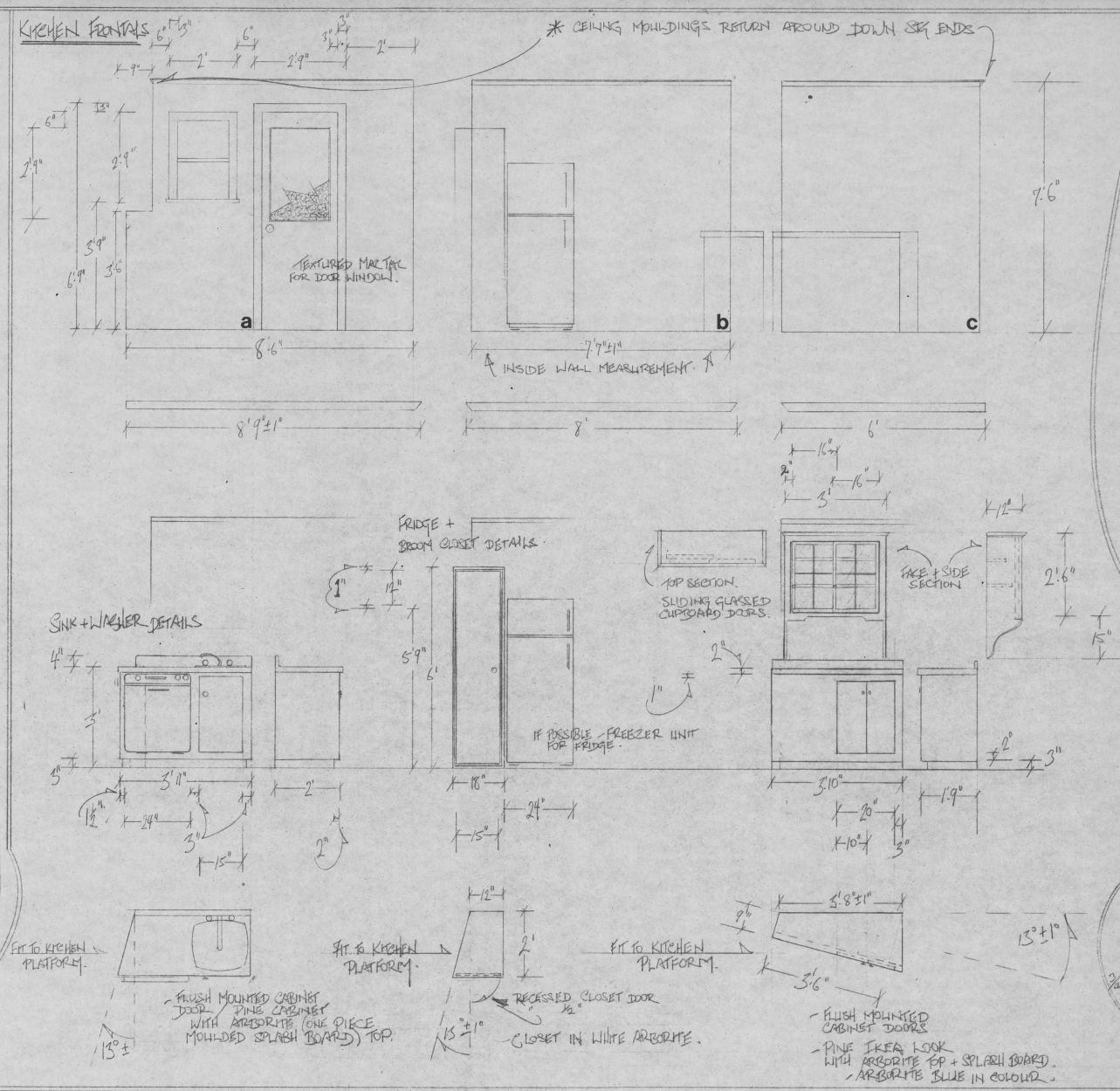
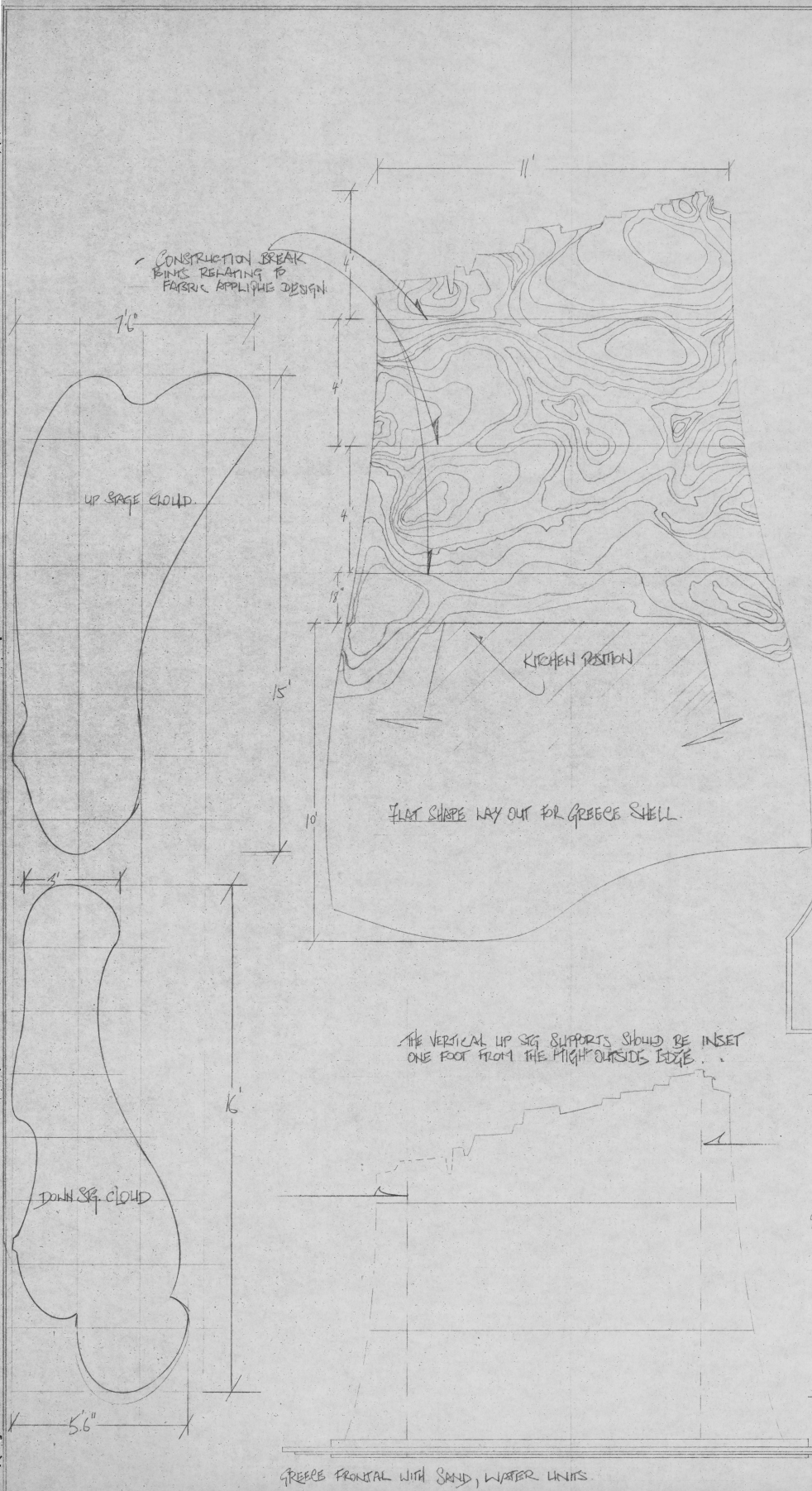

SHIRLEY VALENTINE  
 NEPTUNE THEATRE  
 DIRECTOR - ALLEN MACANNIS  
 DESIGN - STEPHEN DEAR  
 DRAWN BY - GREECE SHELL + SIG  
 - ARCH DETAILS  
 DRAW DATE NOV 15/41  
 SIGN DATE MARCH 6/42  
 SCALE 1/2" = 1 FOOT 50"  
 DRAW No 11/1 FINAL

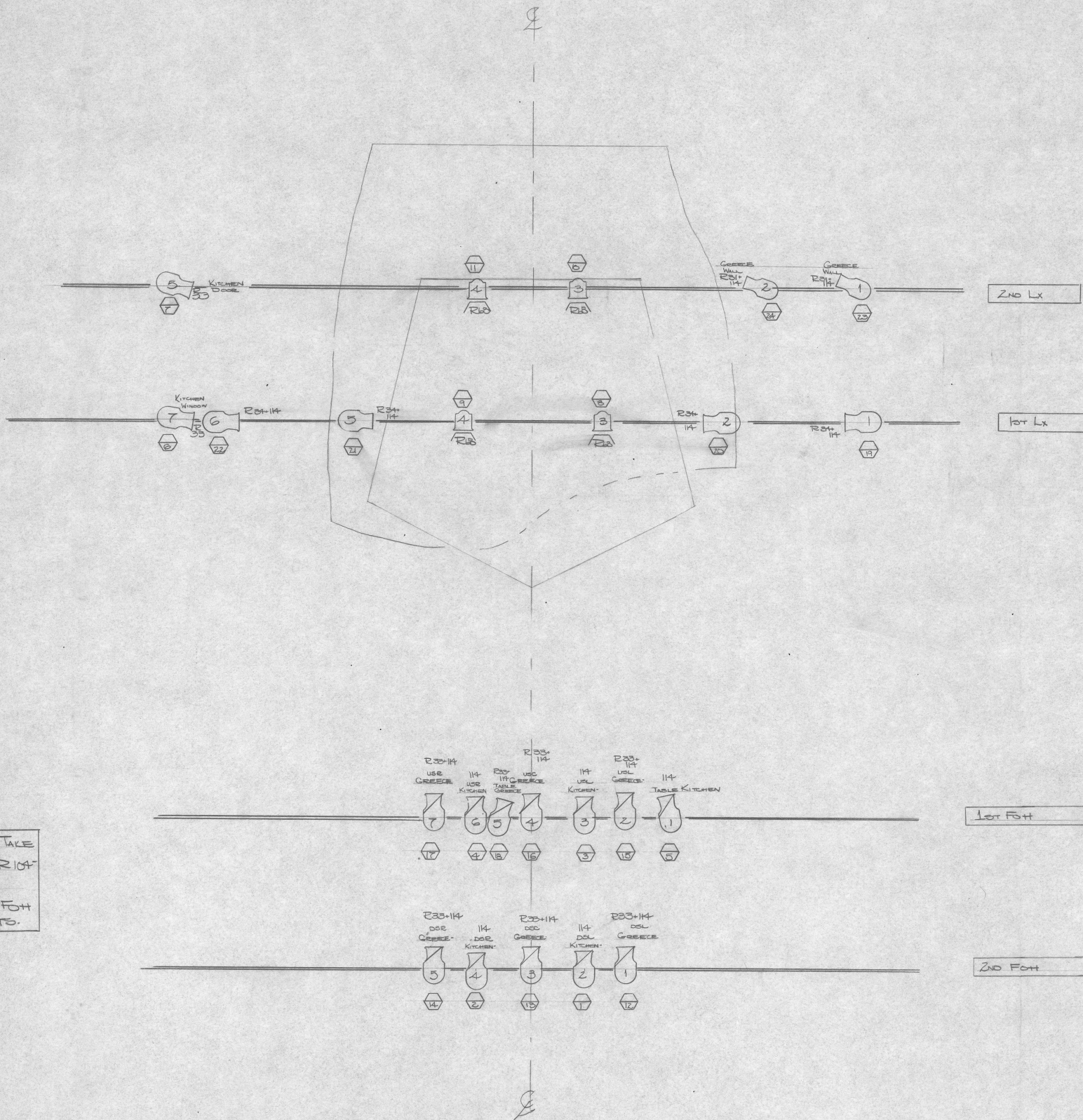

NOTE: PLEASE TAKE  
7/2" CUTS OF R104  
DIRECTIONAL  
FRONT FOR FOH  
INSTRUMENTS.

LEGEND		LAMP TOTAL
	6x9-1KW	6x9-8
	6x12-1KW	6x12-12
	6" FRESNELS w/ BARN DOORS-1KW	6" FRESNEL - 4
	CHANNEL	
	R302 - COLOR	
	TEMPLATE	

SHIRLEY VALENTINE
NEPTUNE TOUR PLOT
DIRECTOR: ALAN MACINNIS
SET DESIGN: STEPHEN OGLER
LIGHTING DESIGN: LESLEY WILKINSON
SCALE: 1/2" = 1'-0"
DATE: MARCH 4, 1992

20	CYC
20	BORDER
24	
28	
22	
21	
20	5" Lx 7'-4" 24'0"
19	
18	Clouds Act 2
17	Clouds Act 2
16	BORDER
15	
14	4" Lx 7'-4" 22'0"
13	BORDER
12	
11	2" Lx 7'-4" 22'0"
10	
9	BORDER
8	
7	2" Lx 7'-4" 22'0"
6	
5	
4	1st Lx 7'-4" 22'0"
3	LEGS
2	HOUSE CURTAIN IN
1	FIRE CURTAIN

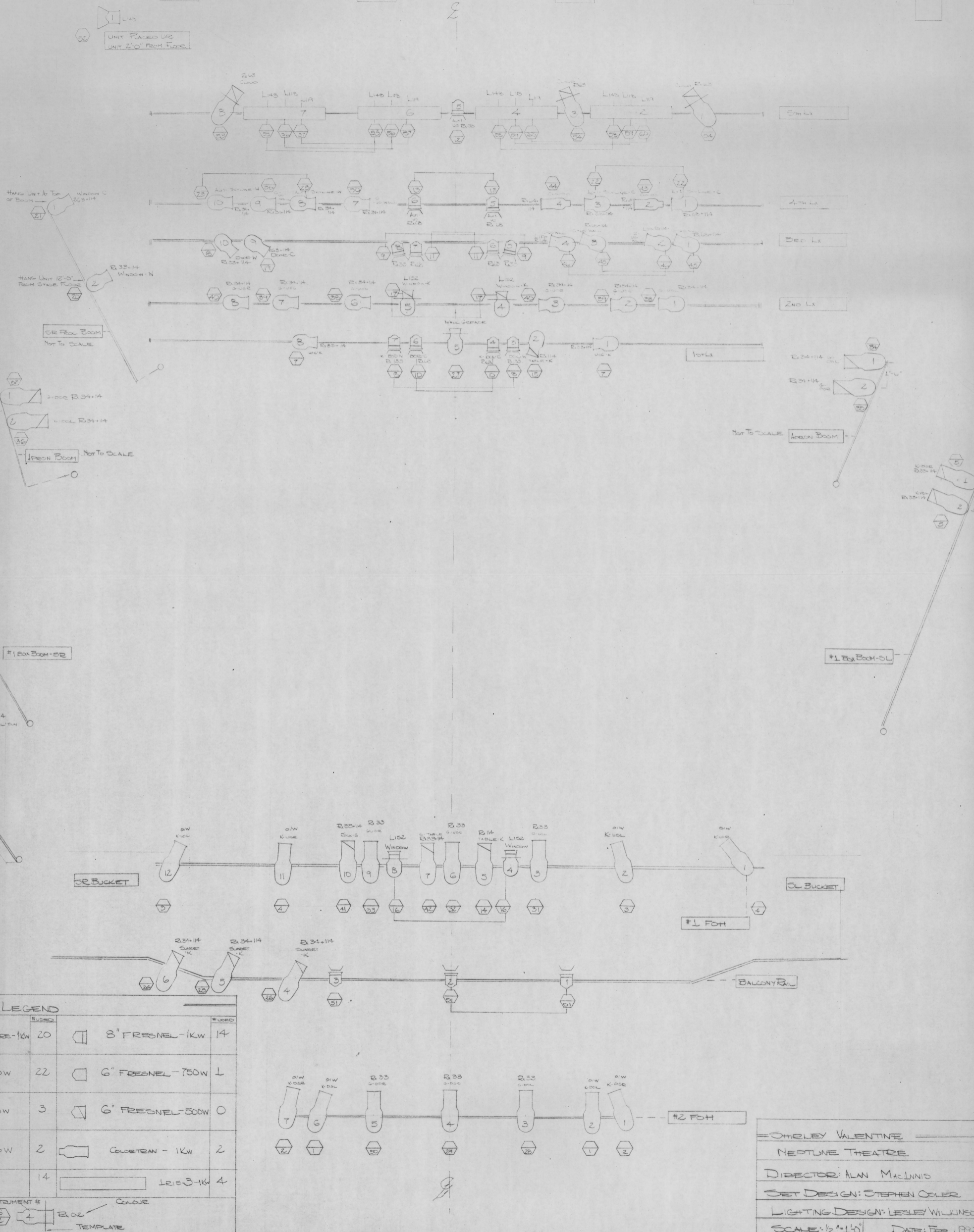

**LEGEND**

	#USED		#USED
	20		14
	22		1
	3		0
	2		2
	14		4

CIRCUIT CHANNEL — INSTRUMENT # — COLOUR — TEMPLATE

— CHURLEY VALENTINE —  
 NEPTUNE THEATRE  
 DIRECTOR: ALAN MACINNIS  
 SET DESIGNER: STEPHEN OCKER  
 LIGHTING DESIGNER: LESLEY WILKINSON  
 SCALE: 1/2" = 1'-0"  
 DATE: FEB. 1992